

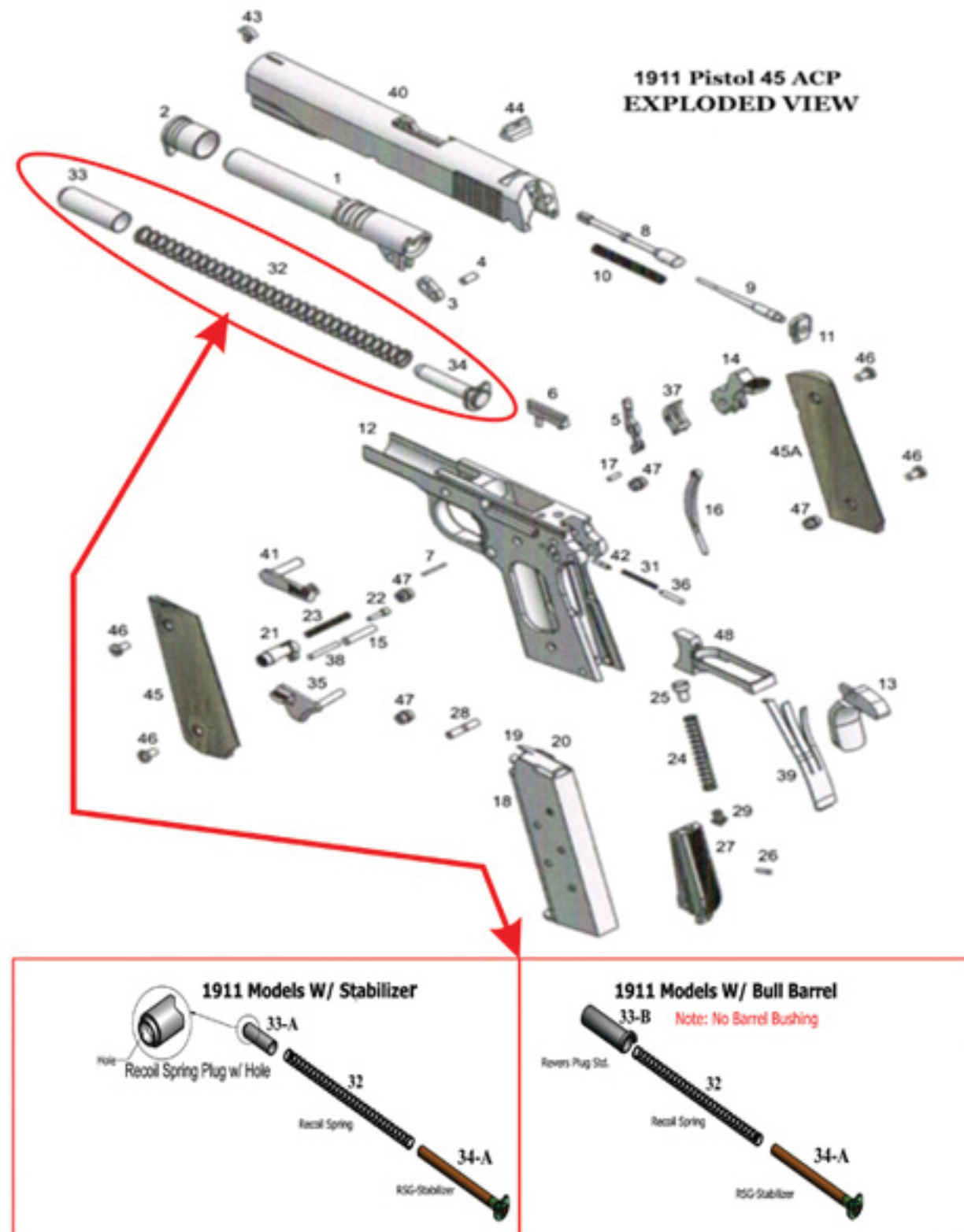

## 1911 Exploded View



### Ref #

### Name

41	Slide Stop
42	Slide Stop Plunger
43	Sight, Front, Fixed
44	Sight, Rear, Fixed
45	Stock (grip) Panel, Left
45.a	Stock (grip) Panel, Right
46	Stock Screw (4)
47	Stock Screw, Bushing (4)
48	Trigger Assembly

### Ref #

### Name

1	Barrel
2	Barrel Bushing
3	Barrel Link
4	Barrel Link Pin
5	Disconnecter
6	Ejector
7	Ejector Retaining Pin
8	Extractor
9	Firing Pin
10	Firing Pin Spring
11	Firing Pin Stop
12	Frame (Receiver)
13	Grip Safety
14	Hammer
15	Hammer Pin
16	Hammer Strut
17	Hammer strut Pin
18	Magazine Body
19	Magazine Follower
20	Magazine Spring
21	Magazine Catch (Body)
22	Magazine Catch Lock
23	Magazine Catch Spring
24	Mainspring (Hammer Spring)
25	Mainspring Cap
26	Mainspring Cap Pin
27	Mainspring Housing
28	Mainspring Housing Pin
29	Mainspring Housing Pin Retainer
30	Plunger Tube
31	Plunger Spring (Safety/ Slide Stop)
32	Recoil Spring
33	Recoil Spring Plug
33-A	Recoil Spring Plug w/ Hole
33-B	Reverse Plug Std.
34	Recoil Spring Guide
34-A	Recoil Spring Guide Stabilizer
35	Safety Lock (Thumb Safety Lever)
36	Safety Lock Plunger
37	Sear
38	Sear Pin
39	Sear Spring
40	Slide